

INSET 1  
Scale 1:250

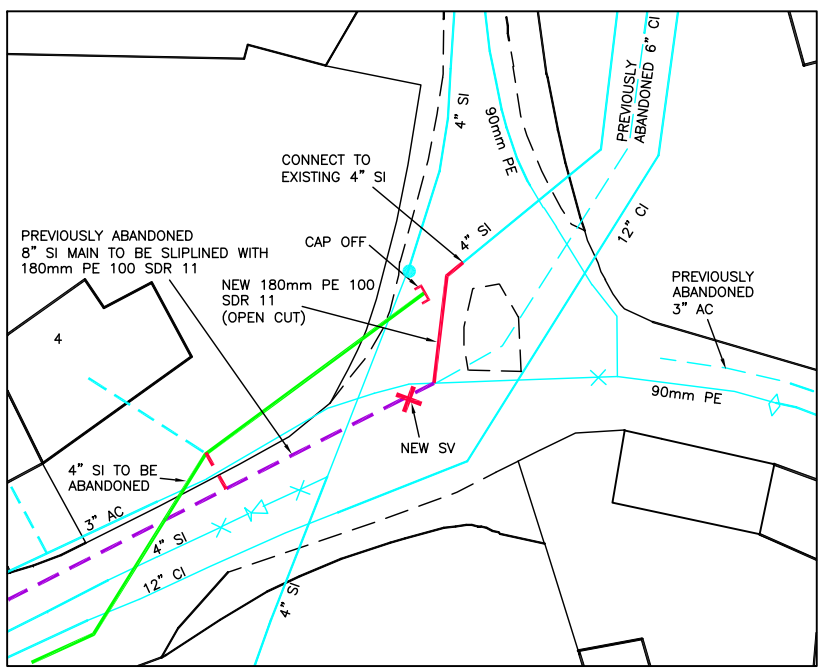

INSET 2  
Scale 1:250

**KEY:**

**PROPOSED**

- OPEN CUT
- - - PIPE BURST
- - - PIPE INSERTION
- - - DIRECTIONAL DRILL
- TO BE ABANDONED
- EXISTING WATER MAIN
- PRIVATE WATER MAIN
- PREVIOUSLY ABANDONED MAIN

**FITTINGS - NEW/REPLACED**

- ⊗ REPLACE SV
- ⊙ FIRE HYDRANT
- ⊖ WO HYDRANT
- ⬠ AIR VALVE
- ⊠ FLOW METER
- ⊗ NEW SV
- ⊙ PRV
- ⊖ NRV
- ⬠ TAPER
- ⊠ SV WITH BYPASS

**FITTINGS - TO BE ABANDONED**

- ⊗ SV
- ⊙ FIRE HYDRANT
- ⊖ WO HYDRANT
- ⬠ AIR VALVE
- ⊠ FLOW METER
- ⊗ PRV
- ⊙ NRV
- ⊖ TAPER
- ⬠ SV WITH BYPASS

**FITTINGS - EXISTING**

- ⊗ SV
- ⊙ FIRE HYDRANT
- ⊖ WO HYDRANT
- ⬠ AIR VALVE
- ⊠ FLOW METER
- ⊗ PRV
- ⊙ NRV
- ⊖ TAPER
- ⬠ SV WITH BYPASS

**SITE ID**

NGR 354962 090631

**NOTES**

- ANY MAPS SHOWN ON THIS DRAWING ARE REPRODUCED FROM THE ORDINANCE SURVEY MAP WITH THE PERMISSION OF HER MAJESTY'S STATIONERY OFFICE © CROWN COPYRIGHT RESERVED, LICENCE No 100019539
- UNLESS NOTED OTHERWISE ALL DIMENSIONS ARE IN MILLIMETRES & ALL LEVELS ARE IN METRES AOD.
- CONNECTION DETAILS TO BE USED FOR GUIDANCE PURPOSES ONLY.
- FIELD MARKER POSTS TO BE INSTALLED AT EVERY BOUNDARY. REFER TO WY STANDARD Drg. No.SD/240.
- CONCRETE MARKER POSTS WITH DIAGRAMMATICS TO BE INSTALLED AT BOUNDARIES AND PLATE TO BE ORIENTATED SO THAT IT IS READ RELATIVE TO PIPE FITTING POSITIONS.
- EXISTING UTILITIES (INCLUDING WESSEX WATER) HAVE BEEN CHECKED ON SITE AND WHERE APPARATUS CAN BE SEEN ABOVE OR AT GROUND LEVEL, THE DESIGNER HAS MADE EVERY EFFORT PRACTICABLE TO USE CORRECT LOCATION AND PLANNED / MAPPED ROUTE BASED ON THIS INFORMATION. WHERE NOT POSSIBLE, LOCATIONS FROM UTILITY PLANS HAVE BEEN USED.
- UPON CONSTRUCTION WORK FINDING EXISTING WESSEX WATER APPARATUS IN DIFFERENT LOCATION TO SHOWN ON DRAWINGS, THE SITE MANAGER SHALL PROVIDE CORRECTED LOCATION FOR 20M IN EACH DIRECTION AS PART OF THE AS-LAID INFORMATION.
- THIS DRAWING TO BE READ IN CONJUNCTION WITH THE CE3MP.
- SLUICE VALVES SHALL BE INSTALLED AS SHOWN IN DETAIL 2 OR DETAIL 6 OF WW STD/211.
- HYDRANTS SHALL BE INSTALLED AS SHOWN IN DETAIL 4 OF WW STD/214.
- OXO's SHALL TYPICALLY BE INSTALLED AS DETAILED IN DETAIL 1 OF WW STD/214 (ISOLATION VALVE BELOW HYDRANT NOT REQUIRED).
- AIR VALVES SHALL BE INSTALLED AS SHOWN IN DETAIL 1 OF WW STD/213.
- SLEEVE INSTALLATIONS AND DIRECTIONAL DRILLS SHALL BE INSTALLED AS DETAILED IN WW STD/257 AND STD/258.
- CONNECTIONS TO BE INSTALLED AS DETAILED IN STD/221.
- ALL CHANGE PROPOSED ON SITE SHALL BE DISCUSSED AND AGREED WITH THE DESIGNER. CHANGE SHALL BE RECORDED AND ADDED TO THE CHANGE REGISTER.
- PROJECT HAS BEEN DESIGNED IN ACCORDANCE WITH WESSEX WATER DS 647 UTILITY MAINLAYING BENCHMARK DESIGN STANDARD.

**SAFETY, HEALTH & ENVIRONMENT (S.H.E.) INFORMATION BOX**

**SAFETY AND HEALTH ISSUES**

SPECIFIC RESIDUAL HAZARDS HAVE BEEN IDENTIFIED ON THE DRAWING WITH THE FOLLOWING SYMBOLS:

KEY	DETAILS
R1	

GENERAL SITE-WIDE UTILITY HAZARDS: (FROM DHC)

OTHER SITE-WIDE RESIDUAL HAZARDS: (FROM DHC)

**ENVIRONMENTAL ISSUES**

SPECIFIC ENVIRONMENTAL ISSUES HAVE BEEN IDENTIFIED ON THE DRAWING WITH THE FOLLOWING SYMBOLS:

KEY	DETAILS
E1	

GENERAL SITE-WIDE ENVIRONMENTAL ISSUES ARE:

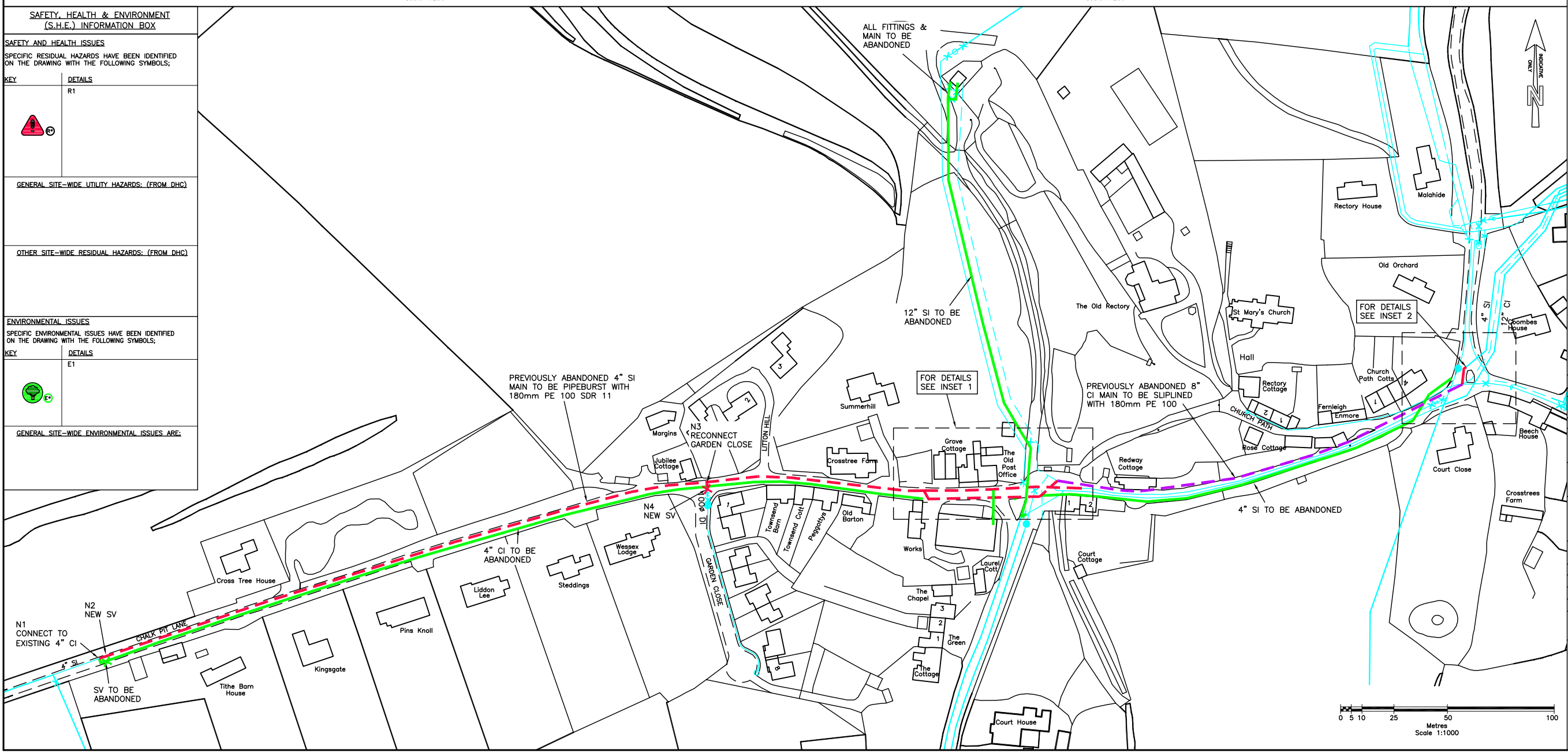

Scale 1:1000

REVISIONS	DRN	CHK	APP	DATE

LITTON CHENEY

MAINS REPLACEMENT

WATER MAIN UPGRADE OVERALL PLAN

**PRELIMINARY**

ORIGINAL DRAWING SIZE A1

INITIALS	DATE	SCALE
AM	19/10/17	1:1000
CAM	20/10/17	1:250

DESIGNED BY: AM

DRAWN BY: CAM

DRAWING NUMBER	REV.
BJ172/0001	A

**Wessex Water**

Wessex Engineering & Construction Services